

# ROSE PRAIRIE - AMES, IOWA

**OWNER/APPLICANT:**  
ROSE PRAIRIE LLC  
1360 NW 121ST STREET  
CLIVE, IOWA 50325  
(515) 964-1229  
ATTN: TERRY LUTZ

**ENGINEER/SURVEYOR:**  
McCLURE ENGINEERING COMPANY  
1360 NW 121ST STREET  
CLIVE, IOWA 50325  
(515) 964-1229  
ATTN: CALEB SMITH

**LEGAL DESCRIPTION:**  
ROSE PRAIRIE FINAL PLAT LOT 2

**PROPOSED ZONING:**  
CONVENIENCE GENERAL SERVICE (CGS)  
RESIDENTIAL MEDIUM DENSITY (FS-RM)  
RESIDENTIAL LOW DENSITY (FS-RL)



building strong communities.

1360 NW 121ST. Street  
Clive, Iowa 50325  
515-964-1229  
fax 515-964-2370

**NOTICE:**  
McClure Engineering Company waives any and all responsibility and liability for problems which arise from failure to follow these Plans, Specifications, and the engineering intent they convey, or for problems which arise from failure to obtain and/or follow the engineers guidance with respect to any errors, omissions, inconsistencies, ambiguities, or conflicts which are alleged.

**COPYRIGHT:**  
Copyright and property rights in these documents are expressly reserved by McClure Engineering Company. No reproductions, changes, or copies in any manner shall be made without obtaining prior written consent from McClure Engineering Company.

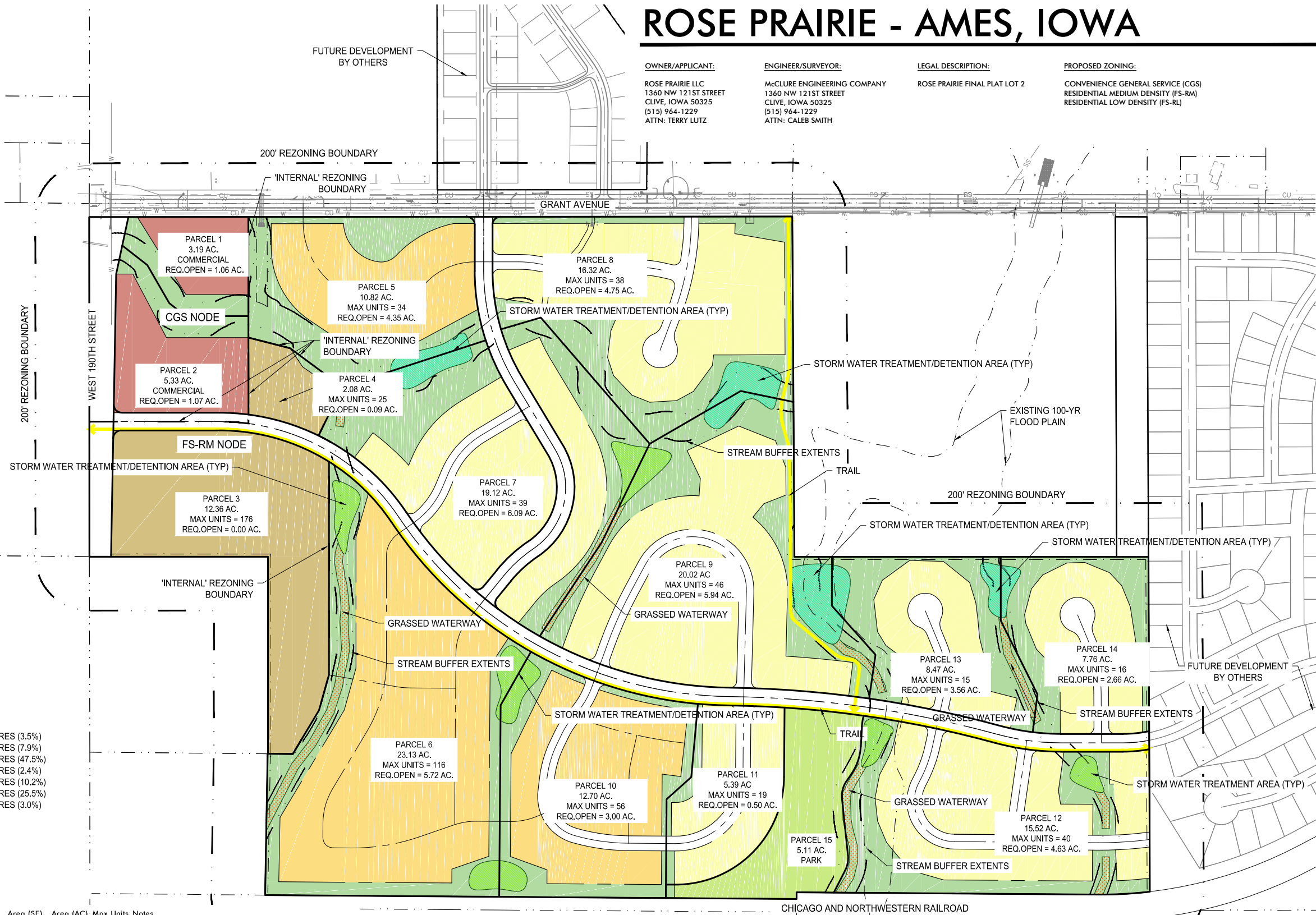

## DEVELOPMENT SUMMARY

TOTAL AREA = 170.33 ACRES

CGS	= 6.01 ACRES (3.5%)
FS-RM	= 13.54 ACRES (7.9%)
FS-RL	= 80.91 ACRES (47.5%)
PUBLIC ROW (IN CGS & FS-RM)	= 4.04 ACRES (2.4%)
PUBLIC ROW (IN FS-RL)	= 17.41 ACRES (10.2%)
DEDICATED OPEN SPACE *	= 43.35 ACRES (25.5%)
PUBLIC PARK*	= 5.07 ACRES (3.0%)

## UNIT SUMMARY

Parcel	Zoning	Land Use	Area (SF)	Area (AC)	Max Units	Notes
1	Commercial General Service	Commercial	138,989	3.19	NA	
2	Commercial General Service	Commercial	232,352	5.33	NA	
3	FS-RM	Medium Density	538,578	12.36	176	12 Units per Building, up to 25% 3 Bed, All others 1 or 2 bed.
4	FS-RM	Medium Density	90,773	2.08	25	12 Units per Building, up to 25% 3 Bed, All others 1 or 2 bed.
5	FS-RL	Single Family Attached	471,148	10.82	34	12 Units attached with rear alley access, 5 units attached without alley
6	FS-RL	Single Family Attached	1,007,484	23.13	116	12 Units attached with rear alley access, 5 units attached without alley
7	FS-RL	Single Family	832,928	19.12	39	
8	FS-RL	Single Family	711,108	16.32	38	
9	FS-RL	Single Family	872,028	20.02	46	
10	FS-RL	Single Family Attached	553,209	12.70	56	12 Units attached with rear alley access, 5 units attached without alley
11	FS-RL	Single Family	234,911	5.39	19	
12	FS-RL	Single Family/Villas	675,840	15.52	40	
13	FS-RL	Single Family	368,977	8.47	15	
14	FS-RL	Single Family	337,960	7.76	16	

## NOTES

- 1) ALL GREEN SPACE AREAS AND LOT CONFIGURATIONS INSIDE THE PARCEL BOUNDARIES ARE TO BE DEPICTED AND DESIGNED BY FUTURE PRELIMINARY PLAT(S). \*OPEN SPACE AREAS INSIDE INDIVIDUAL PARCEL BOUNDARIES IN RED HAVE NOT BEEN INCLUDED IN THE OVERALL OPEN SPACE CALCULATIONS.
- 2) STREET ALIGNMENTS ARE GENERALIZED.
- 3) \*OPEN SPACE REQUIRED (25%) INCLUDES BOTH DEDICATED OPEN SPACE AND CITY PARK. 28.5% IS PROVIDED.
- 4) NO MORE THAN 25% OF THE UNITS IN ANY ONE APARTMENT BUILDING CAN CONTAIN THREE BEDROOMS. ALL OTHER UNITS SHALL BE ONE- OR TWO-BEDROOM UNITS.
- 5) PARCELS 5, 6, AND 10 ALLOW 5 UNITS ATTACHED OR 12 UNITS ATTACHED WITH REAR ALLEY ACCESS.

## ROSE PRAIRIE REVISED MASTER PLAN

AMES, IA  
2212007  
AUGUST 10, 2016

REVISIONS

ENGINEER  
C. SMITH

DRAWN BY  
J. BECKER

CHECKED BY  
C. SMITH

FIELD BOOK NO.

DRAWING NO.  
MP-01

SHEET NO.  
1 / 1

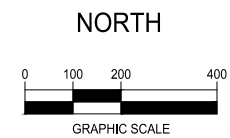

N:\Land Development\Projects\Rose Prairie\Rose Prairie Master Plan with parcel lines.dwg 2/24/2017 9:35 AM